



# conference room configurations

# Meeting Facilities at RYDGES

Conferences | Events | Functions



ballrooms A, B, C & Foyer



steeds restaurant & bar



strawberry road



executive boardroom



kingston suite

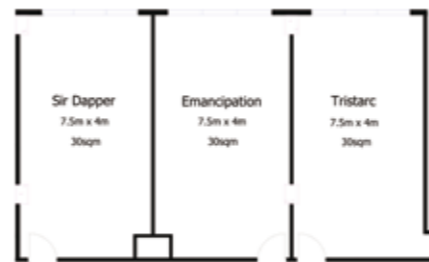

standard boardroom

ROOM	DIMENSIONS	U-SHAPE	THEATRE	CLASSROOM	CABARET	BANQUET	COCKTAIL	BOARDROOM
Ballroom A								
Ballroom B	5.8 x 9m	18	45	21	24	30	60	18/20
Ballroom C								
Ballroom ABC	17.4 x 9m	60 cbl	150	80	108	120	200	-
Ballroom Foyer		18	100	24	90	120	200	
Triple Crown Ballroom		60 cbl	400	180	270	300	400	-
Sir Dapper								
Tristarc								
Emancipation	7.5 x 4m	10	26	10	16	20	25	16/18
Kingston Town								
Myocard								
Vo Rogue								
Myocard / Vo Rogue	7.5 x 8m	18	55	30	32	40	50	20
Kingston Suite	7.5 x 12m	30	90	40	54	60	80	30
Executive Boardroom	7.5 x 5.8m	18	45	21	24	30	40	20
Strawberry Road	12.3 x 5m	25	60	24	30	40	50	20
Steeds		30	80	30	45	100	100	25



# fact sheet

## conference feature

On the edge of Parramatta CBD stands Rydges Parramatta. This hotel's contemporary style incorporates spacious facilities overlooking the impressive Rosehill Gardens Racecourse and Grand Pavilion. Rydges Parramatta is close to Olympic Park, Acer Arena, ANZ Stadium, Parramatta Stadium, Sydney Showground & Exhibition Complex, and Eastern Creek Raceway. Rydges Parramatta Mezzanine Level is exclusive to conferences and functions with convenient access to hotel lifts, accommodation rooms, bars and restaurants.

Our dedicated Banquets kitchen team will guarantee fast food service for all breaks. The versatility of our two in-house restaurants ensures we provide your delegates with a genuine choice of dining venues.

With 151 designer look guest rooms Rydges Parramatta is truly able to offer a conferencing solution for the mid-sized residential market.

The Hotel features 18 conference / event venues catering from 2 to 400 guests.

## unique benefits

- Natural light in all function rooms
- Air conditioned and individually controlled lighting
- Flexible break out areas
- Large pre function space
- Convenient access via hotel lifts or one flight of stairs
- Full event coordination & support
- 200 complimentary open air car spaces
- Fully sound proofed room dividers, dividing two venues into three separate areas
- High Speed Broadband Internet Access
- State of the art audio visual equipment
- In-Room Telephone and modem point

## hotel facilities

- 24hr reception
- 24hr Room Service
- Gymnasium, Spa and Heated Indoor Pool
- Turkish Steam Bath
- External Laundry and Valet Service
- TAB Facilities
- Weekend, Morning and Evening Courtesy Shuttle operating within a 5km radius.
- Express Check in and Check out
- Business Centre on request
- Safety Deposit Boxes
- On-site ATM
- Gaming Room
- Beer Garden

## room facilities

- Minibar
- IDD Direct Dial Telephone and Direct Dial Operator Assisted Calls
- Iron and Ironing Board
- In-house pay per view movies
- Hairdryers
- Tea & Coffee making facilities
- Individually controlled climate control facilities
- High Speed Broadband Internet Access
- Foxtel
- Entertainment Hub
- LCD Flatscreen Televisions
- Ergonomic Workstations
- Rydges Dream Beds
- On Demand Movies

## dining concepts



**Stock Dining Room & Café**  
A lively café serving colourful, fresh, modern food attuned to today's business traveller. Open continuously for breakfast through to dinner with enough variety to suit everyone's taste. Come and experience Parramatta's best breakfast where Chef's at our "Egg Bar" cook your eggs just the way you like them! The live cooking station invites guests to become a part of the Stock dining experience.



**Steeds Club Grill & Bar**  
An intimate club grill and bar where you can enjoy the finest seafood and top quality beef complemented by extensive wine lists featuring well known Australian Wineries.  
Open for dinner Monday - Friday and Race Day Saturdays.



**Champs Bar**  
Specialising in boutique tap beers, cocktails and wines. Entertainment is provided on race day Saturdays.  
Champs is open Monday through to Saturday from 4.30pm.



**The Winning Post Bar - 'The Post'**  
Relaxed alfresco style pub with icy cold beer and snack foods. TAB Facilities and Pokies. Enjoy a casual drink in the open beer garden and BBQ area or challenge friends to a game of pool under the marquee.  
Open daily from 12 noon.

## local attractions

Located directly opposite Rosehill Gardens Racecourse & Exhibition Centre, Rydges Parramatta is located close to Olympic Park precinct, Acer Arena, ANZ Stadium, Parramatta Ferry Terminal and Parramatta CBD.



## how to get there

From Sydney International Airport travel along Southern Cross Drive following the signs to Parramatta / Blue Mountains via Parramatta Road. Follow signs to the M4 Motorway, then take the M4. Turn off at James Ruse Drive / Rosehill Gardens Racecourse. Rydges Parramatta is clearly visible from the motorway.

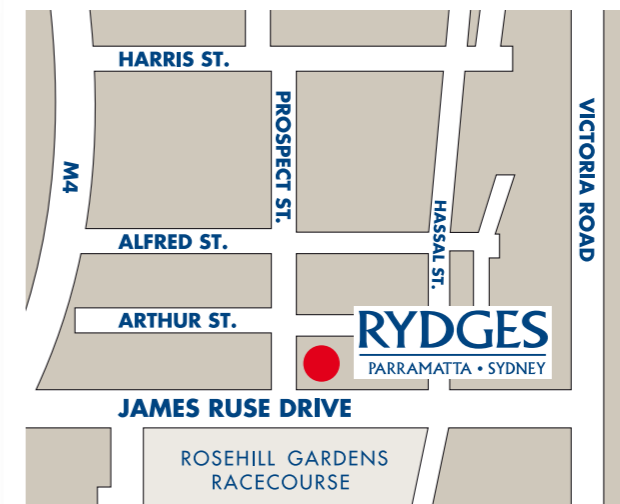

# RYDGES

PARRAMATTA • SYDNEY

116-118 James Ruse Dr,  
Rosehill NSW 2142  
Phone: 61 2 8863 7600  
Fax: 61 2 8863 7601  
Toll Free: 1800 857 922  
functions\_parramatta@rydges.com  
www.rydges.com/parramatta

## Conference Triple AAA Instant Service Guarantee

Anywhere, Anything, Anytime. Enjoy a hassle free event with our Triple AAA Instant Service Guarantee

— our banquet team are available at anytime for your convenience.

**eventsatrydges**  
www.rydges.com/events